

Z-Wave Curtain Motor Controller SR-ZV9080A-A

Function Introduction

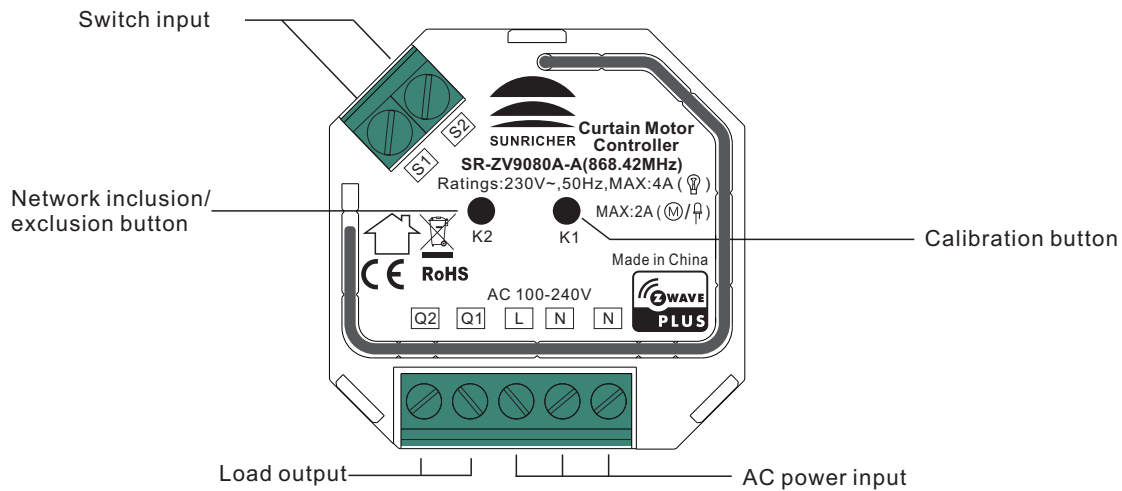

Safety & Warnings

- DO NOT install with power applied to device.
- DO NOT expose the device to moisture.

Quick Start

How to install:

- Step 1: power on the Z-Wave curtain motor controller.
- Step 2: activate inclusion mode on your Z-Wave controller.
- Step 3: activate inclusion mode of the curtain motor controller by triple press the network inclusion/exclusion button. The curtain motor controller will be included to Z-Wave network.

Product Description

The curtain motor controller is a universal, Z-Wave Plus compatible, electric motor controller. The device allows for controlling motors of roller blinds and venetian blinds, which are single phase AC powered. The curtain motor controller allows for precise positioning of a roller blind or venetian blind slats. Precise positioning is available for the motors equipped with mechanic and electronic end switches. The device also allows for controlling on/off of lights. The module may be controlled wirelessly, through the Z-Wave network primary controller, or through the switch keys connected to it. In addition, the curtain motor controller is equipped with Power Metering and over current protection.

The curtain motor controller can be included and operated in any Z-Wave network with other Z-Wave certified devices from other manufacturers and/or other applications. All non-battery operated nodes within the network will act as repeaters regardless of vendor to increase reliability of the network.

The encryption mode that the curtain motor controller supports is S2 Unauthenticated. When the device is being included into a Z-Wave network, you can use your primary controller/gateway to enable encryption mode or disable encryption. (The primary controller/gateway shall support encryption mode configuration). The curtain motor controller supports OTA and can update firmware wirelessly.

Main Features:

- Compatible with any Z-Wave or Z-Wave+ Controller,
- Controlled by Sunricher EasyHome or any other Z-Wave controller,
- Advanced microprocessor control
- Active element: electromagnetic, micro-gap relay switch
- The device may be operated by momentary or toggle switches, and by dedicated roller blind control switches
- Connected motor's current and historical power consumption measured
- Over current protection
- To be installed in wall switch boxes of dimensions allowing for installation, conforming to provisions of applicable regulations
- The curtain motor controller supports OTA and can update firmware wirelessly

Product Data

Z-Wave Frequency	868.42 MHz (EU)
Input Voltage	AC100-240V
Output Voltage	AC100-240V
Max. Load Current	Resistive loads:4A Capacitive/inductive loads:2A
Operating temperature	0 to 40°C
Relative humidity	8% to 80%
Dimensions	45.5x45x20.3mm

Installation Guide

Please read carefully the enclosed user manual before installation of the curtain motor controller, in order to ensure an error-free functioning.

ATTENTION: Prior to the assembly of the product, the voltage network has to be switched OFF and ensured against re-switching.

Inclusion (adding to a Z-Wave network)

1. Set primary controller/gateway into inclusion mode (Please refer to your primary controller's manual on how to turn your controller into inclusion).

2. Power on the curtain motor controller and set it into inclusion mode. There are two methods to set the roller shutter into inclusion mode:

1)Triple press the network inclusion/exclusion button, it will set the curtain motor controller into inclusion

mode. 6 seconds timeout if there is no reply from the Z-Wave primary controller, repeat the operation.

2) When the value of configuration parameter 8 is set as 1, triple press the switch connected to S1, it will set the curtain motor controller into inclusion mode. 6 seconds timeout if there is no reply from the Z-Wave primary controller, repeat the operation.

3. The curtain motor controller will be added to the Z-Wave network.

Exclusion (removing from a Z-Wave network)

1. Set the primary controller/gateway into exclusion mode (Please refer to your primary controllers manual on how to set your controller into exclusion).

2. Power on the curtain motor controller and set it into exclusion mode. There are two methods to set the curtain motor controller into exclusion mode:

1) Triple press the network inclusion/exclusion button, it will set the curtain motor controller into exclusion mode. 6 seconds timeout if there is no reply from the Z-Wave primary controller, repeat the operation.

2) When the value of configuration parameter 8 is set as 1, triple press the switch connected to S1, it will set the curtain motor controller into exclusion mode. 6 seconds timeout if there is no reply from the Z-Wave primary controller, repeat the operation.

3. The curtain motor controller will be removed from the Z-Wave network.

Factory Reset

Press and hold down network inclusion/exclusion button for over 10 seconds, the curtain motor controller will be reset to factory defaults.

Configure Parameter 3 to Set Working Mode

1. When parameter 3 value is configured as 0, light mode: either S1 or S2 can control both Q1 and Q2, pulse signal or level signal will be recognized automatically. For detailed configuration please refer to configuration parameter 7.

Note: when configured as light mode, endpoint 1 reflects to relay 1 (Q1), endpoint 2 reflects to relay 2 (Q2).

2. When parameter 3 value is configured as 1, shutter mode without positioning: S1 and S2 are only valid with level signal. Short press S1, relay 1 (Q1) ON, relay 2 (Q2) OFF. Short press S2, relay 2 (Q2) ON, relay 1 (Q1) OFF.

3. When parameter 3 value is configured as 2, shutter mode with positioning: S1 and S2 are only valid with level signal. Short press S1, relay 1 (Q1) ON, relay 2 (Q2) OFF. Short press S2, relay 2 (Q2) ON, relay 1 (Q1) OFF. When reaching both ends' positioning, both relays will be OFF.

4. When parameter 3 value is configured as 3, venetian mode (up/down and slats rotation): Short press S1, relay 1 (Q1) ON, relay 2 (Q2) OFF. Short press S2, relay 2 (Q2) ON, relay 1 (Q1) OFF. When reaching both ends' positioning, both relays will be OFF. This mode supports shutter dim command, which means it supports the secondary switch of command class SWITCH_MULTILEVEL_START_LEVEL_CHANGE.

Association

Z-Wave devices control other Z-Wave devices. The relationship between one device controlling another device is called association. In order to control a different device, the controlling device needs to maintain a list of devices that will receive controlling commands. These lists are called association groups and they are always related to certain events (e.g. button pressed). In case the event happens all devices stored in the respective association group will receive a common wireless command.

Association Groups:

Association Groups	Group Name	Max Nodes	Description
Group 1	Lifeline	5	1. When press and hold down "K2" button for 10S to reset the device, send "Device Reset Locally Notification" to associated devices of this group to report factory reset information. 2. When over load detected, send "NOTIFICATION_REPORT" to associated devices of this group.
Group 2	REP EP1	5	When endpoint 1 state changes, send "SWITCH_MULTILEVEL_REPORT" to associated devices of this group.
Group 3	REP EP1	5	When endpoint 2 state changes, send "SWITCH_BINARY_REPORT" to associated devices of this group.

Set and unset associations:

(Note: All association information will be cleared automatically once the curtain motor controller is excluded from a network.)

Set association by operating primary controller/gateway to send packets to the curtain motor controller:

The primary controller/gateway sends packets to the curtain motor controller using "Command Class ASSOCIATION"

Node Information Frame

The Node Information Frame is the business card of a Z-Wave device. It contains information about the device type and the technical capabilities. The inclusion and exclusion of the device is confirmed by sending out a Node Information Frame. Beside this it may be needed for certain network operations to send out a Node Information Frame.

How to send out Node Information Frame:

When the curtain motor controller is set to inclusion/exclusion mode again, it will send out Node Information Frame, there are 2 kinds of operation as follows:

1. triple press the K2 button, the curtain motor controller will be set to inclusion/exclusion mode, then send out Node Information Frame.

2. When the curtain motor controller is under inclusion mode, there are two kinds of operation:

1) Triple press K2 button, the curtain motor controller will be set to inclusion mode again, and send out Node Information Frame.

2) Power off and power on the curtain motor controller, it will be set to inclusion mode automatically, and send out Node Information Frame.

Technical Data

Wireless Range	up to 100 m outside, on average up to 40 m inside buildings
SDK	6.71.03
Explorer Frame Support	Yes
Device Type	Window Covering Position/Endpoint Aware
Generic Device Class	GENERIC_TYPE_SWITCH_MULTILEVEL
Specific Device Class	SPECIFIC_TYPE_CLASS_C_MOTOR_CONTROL
Role Type	Always On Slave (AOS)

Endpoint 1 device type :

GENERIC_TYPE_SWITCH_MULTILEVEL/SPECIFIC_TYPE_CLASS_C_MOTOR_CONTROL

Endpoint 2 device type:

GENERIC_TYPE_SWITCH_BINARY/SPECIFIC_TYPE_POWER_SWITCH_BINARY

SUPPORTED COMMAND CLASS

Root Device Command List

Node Info		Support S2/S0
COMMAND_CLASS_ZWAVEPLUS_INFO	V2	
COMMAND_CLASS_SECURITY	V1	
COMMAND_CLASS_SECURITY_2	V1	
COMMAND_CLASS_TRANSPORT_SERVICE	V2	
COMMAND_CLASS_SUPERVISION	V1	
COMMAND_CLASS_BASIC	V1	YES
COMMAND_CLASS_SWITCH_BINARY	V1	YES
COMMAND_CLASS_SWITCH_MULTILEVEL_V3	V3	YES
COMMAND_CLASS_ASSOCIATION	V2	YES
COMMAND_CLASS_ASSOCIATION_GRP_INFO	V1	YES
COMMAND_CLASS_VERSION	V2	YES
COMMAND_CLASS_MANUFACTURER_SPECIFIC	V2	YES
COMMAND_CLASS_DEVICE_RESET_LOCALLY	V1	YES

COMMAND_CLASS_POWERLEVEL	V1	YES
COMMAND_CLASS_CONFIGURATION	V1	YES
COMMAND_CLASS_FIRMWARE_UPDATE_MD_V2	V4	YES
COMMAND_CLASS_NOTIFICATION_V3	V3	YES
COMMAND_CLASS_METER	V3	YES
COMMAND_CLASS_MULTI_CHANNEL	V3	YES
COMMAND_CLASS_MULTI_CHANNEL_ASSOCIATION	V2	YES

Endpoint 1 Command List

Node Info		Support S2/S0
COMMAND_CLASS_ZWAVEPLUS_INFO	V2	
COMMAND_CLASS_SECURITY	V1	
COMMAND_CLASS_SECURITY_2	V1	
COMMAND_CLASS_SUPERVISION	V1	
COMMAND_CLASS_BASIC	V1	YES
COMMAND_CLASS_SWITCH_BINARY	V1	YES
COMMAND_CLASS_SWITCH_MULTILEVEL_V3	V3	YES
COMMAND_CLASS_ASSOCIATION	V2	YES
COMMAND_CLASS_ASSOCIATION_GRP_INFO	V1	YES
COMMAND_CLASS_MULTI_CHANNEL_ASSOCIATION	V2	YES

Endpoint 2 Command List

Node Info		Support S2/S0
COMMAND_CLASS_ZWAVEPLUS_INFO	V2	
COMMAND_CLASS_SECURITY	V1	
COMMAND_CLASS_SECURITY_2	V1	
COMMAND_CLASS_SUPERVISION	V1	
COMMAND_CLASS_BASIC	V1	YES
COMMAND_CLASS_SWITCH_BINARY	V1	YES
COMMAND_CLASS_ASSOCIATION	V2	YES
COMMAND_CLASS_ASSOCIATION_GRP_INFO	V1	YES
COMMAND_CLASS_MULTI_CHANNEL_ASSOCIATION	V2	YES

Notification Report

Notification Type	Triggerring Event
NOTIFICATION_TYPE_POWER_MANAGEMENT(08)	POWER_MANAGEMENT_OVERCURRENT_DETECTED(06)

Configuration Command Class

Parameter	Size	Description	Default Value
0x02(2)	1	Enable/disable the curtain motor controller to report state change percentage threshold (report only when change value at the specified percentage), if enabled, report when the value reaches both 0% and 99%. When the working mode is configured as light mode, as long as the state changes, the state change percentage threshold will be reported. SWITCH_MULTILEVEL_REPORT 0: disable to report actively 1-10: value to report, unit is one percent	1
0x03(3)	1	Working mode 0: light mode 1: Shutter mode without positioning 2: Shutter mode with positioning 3: venetian mode (up/down and slats rotation)	2
0x04(4)	1	Enable/disable to save positioning percentage, record and save current positioning every time when the curtain moves to specified position, if the working mode is configured as light mode, record on/off state. 0x00: disable 0x01: enable	1
0x05(5)	1	Enable/disable over current protection 0: disable 1: enable, when over current detected, there are two methods to cancel alarm: 1. short press either switch button S1 or S2, the alarm will last at least 1 minute and then be cancelled. 2. re-power on the curtain motor controller	1

0x06(6)	1	<p>Only value 1 can be written in, which means starting positioning calibration. When read, 0x01: positioning calibration completed 0x00: positioning not calibrated</p> <p>This parameter is only valid when parameter 3 configured as shutter mode with positioning or venetian mode (up/down and slats rotation).</p>	0
0x07(7)	1	<p>When parameter 3 value configured as 0 (light mode), configuration of button S1 and S2 control.</p> <p>Value=0 Short press S1 to switch ON/OFF Q1. Press and hold down S1 to switch ON Q1, then release to switch OFF Q2. Short press S2 to switch ON/OFF Q2. Press and hold down S2 to switch ON Q2, then release to switch OFF Q2.</p> <p>Value=1 Short press S1 to switch ON/OFF Q1. When S1 is pressed and held down, then released, not processed. Short press S2 to switch ON/OFF Q2. When S2 pressed and held down, then released, not processed.</p> <p>Value=2 Press and hold down S1 to switch ON Q1, then release to switch OFF Q2. When S1 short pressed, not processed. Press and hold down S2 to switch ON Q2, then release to switch OFF Q2. When S2 short pressed, not processed.</p> <p>Value=3 Short press S1 or S2 to switch ON/OFF of both Q1 and Q2 simultaneously. When S1 or S2 pressed and held down, not processed</p> <p>Value=4 Press and hold down S1 to switch ON Q1 and Q2. When S1 short pressed, not processed. Press and hold down S2 to switch OFF Q1 and Q2. When S2 short pressed, not processed.</p>	0

0x08(8)	1	<p>Enable/disable to add the device to or remove it from a Z-Wave network through button S1. Please refer to the parts of inclusion and exclusion for details.</p> <p>0: enable</p> <p>1: disable</p>	1
0x0A(10)	1	<p>Power change absolute threshold, unit is W</p> <p>0: disable absolute threshold function</p> <p>1-100: value of the power change absolute threshold</p>	10
0x0B(11)	1	<p>Current change absolute threshold, unit is 0.1A</p> <p>0: disable absolute threshold function</p> <p>1-10: value of the current change absolute threshold</p>	0
0x0C(12)	1	<p>Voltage change absolute threshold, unit is 1V</p> <p>0: disable absolute threshold function</p> <p>1-10: value of the voltage change absolute threshold</p>	0
0x0d(13)	1	<p>Slats rotation time, unit is 0.1S</p> <p>0: disable the function</p> <p>5-250 (0.5S-25S): value of the slats rotation time</p> <p>This parameter is only valid when parameter 3 is configured as venetian mode (up/down and slats rotation).</p>	15 (1.5S)
0x0E(14)	1	<p>Time cycle to report power value (unit is KWH) actively</p> <p>0: disable to report</p> <p>60-2678400 (31 days), value of the time cycle, unit is S.</p>	3600 (1 hour)

Wiring Diagram

Notes for the diagrams:

L - terminal for live lead

N - terminal for neutral lead

S1 - terminal for switch key No. 1 (enable to set the device into inclusion/exclusion mode)

S2 - terminal for switch key No. 2



Q1 - output terminal no. 1 for electrical motor

Q2 - output terminal no. 2 for electrical motor

K1 - positioning calibration button when working mode is configured as shutter mode with positioning or venetian mode (up/down and slats rotation)

K2 - inclusion/exclusion button (used to add or remove a device from the system)

Compatible Load Types

Supported load types		100-240V~
	Lamp and resistive loads	Max. 4A
	Inductive loads	Max. 2A
	Capacitive loads	Max. 2A

(1) Curtain Motor Connection Diagram

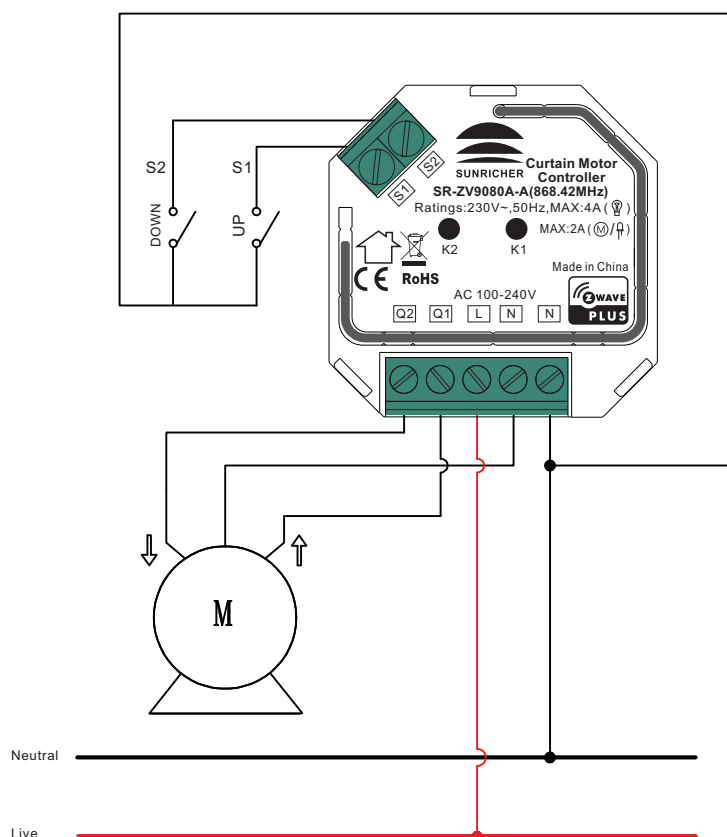

(2) Light Mode Connection Diagram

