

Neon Flex Mini Sideview - RGBW (4000K) | NEOLINEAR™



Product Code:	101.991
Product Type:	Neonlinear™ Sideview
Guarantee Period:	3 Years

Features & Benefits:

- High grade RGBW LED Mini Neon Flex
- Over 16 million colour combinations + Natural white
- 1m tails to both ends
- IP67 rated for outdoor / indoor use
- Side view (Flexes left and right)
- 50mm Maximum bend Diameter

 **700g /roll appx**  **2oz PCB Weight**

Dimensions (Unit: mm)

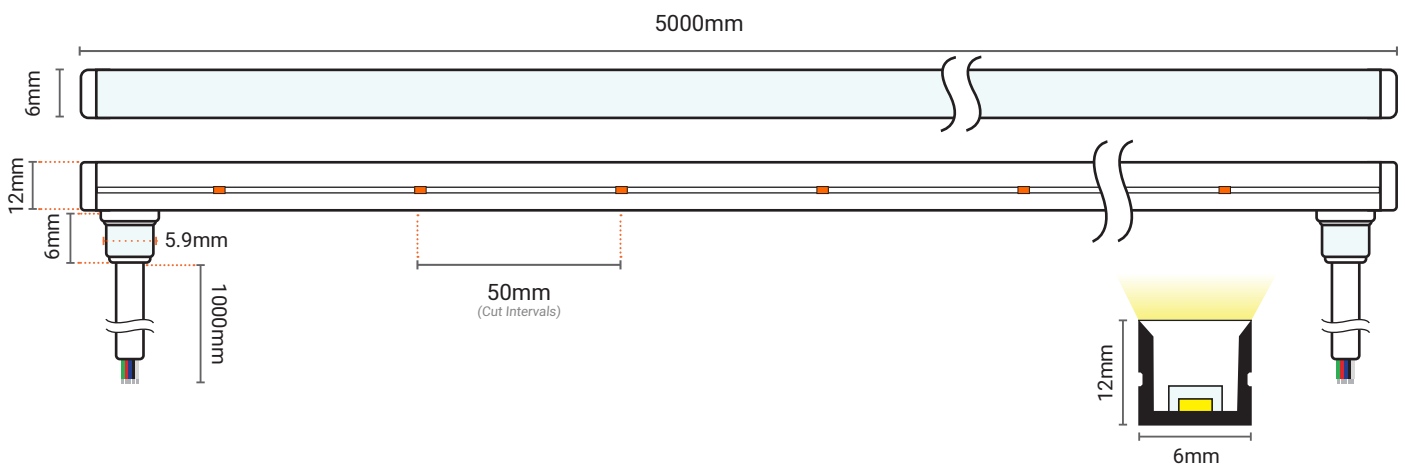

Notes:

- The Neonlinear™ Sideview Mini cutting points are situated 50mm apart from each other. The cutting marks are shown as a copper tab, recessed on the side of the Neon Flex. The LED Strip must **NOT** be cut anywhere else.
- This Neon Flex (Sideview) can be bent Left and Right like a snake. Do not try and bend it Upwards & Downwards like a rollercoaster, otherwise you will risk damaging the product.

We reserve the right to change specifications without notice. E&OE. If you require Technical support or for general enquiries, please do not hesitate to contact one of our LED Technical experts on the contact information provided.

Colour:	Sideview Mini RGB+4000K
Power:	50W
Current:	425mA/M
Input Voltage:	24V DC
Cut Intervals:	50mm
LED Quantity:	240 LEDs
LED Type:	120xLEDs SMD2835 RGB + 120xLEDs 2216 4000K
Cross Section:	6x12mm
Beam Angle:	120°
CRI Rating:	NW 4000K >90
Lumens per LED:	RGB: 171 4000K: 162 (lm/m)
Lumens per Metre:	293lm/m
Power Consumption per Metre:	10W
IP Rating:	IP67
Average LED Lifetime:	35,000 Hours
Reel Size:	6 x 12 x 5000 (mm)
Reel Length:	10 Metres
Base Type (Both Sides):	Rear mould injection 50cm Cables
CE & RoHS	Yes
Continuous Run:	5 Metres
Cables:	1 Metre Cables (Both Ends)



Opening times

Mon-Thur: 8:30am - 5:00pm
Fri: 8:30am - 4:30pm

Telephone: 01260 540014
www.ledtechnologies.co.uk

Neon Flex Mini Sideview - RGBW (4000K) | NEOLINEAR

101.991 Connection Diagram

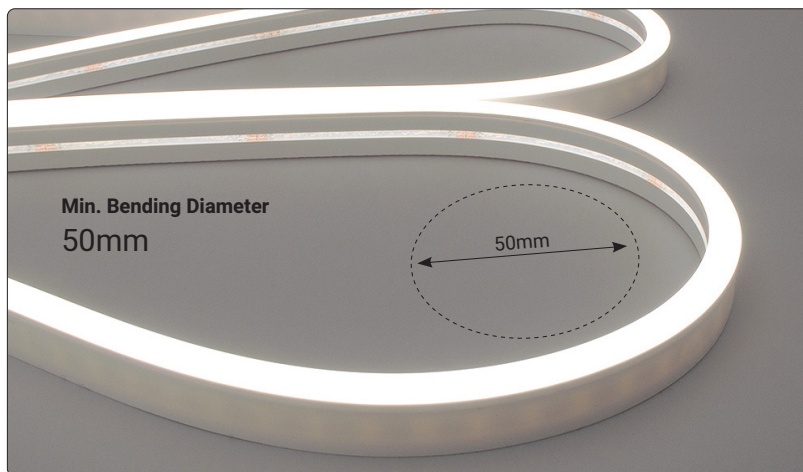
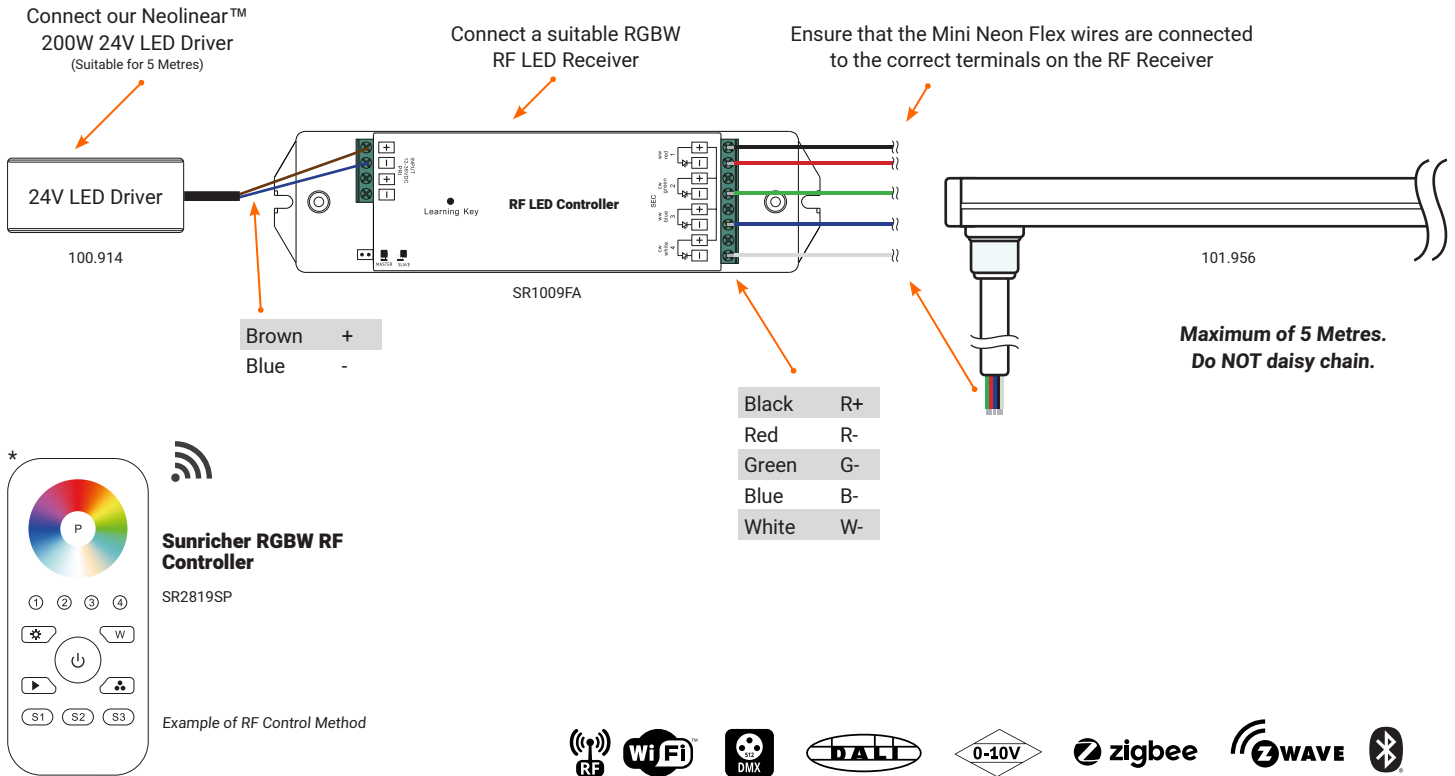

Notes:

- This Neolinear™ Mini product is powered by 50W, so we recommend using our **200W Neolinear™ LED Driver** (100.914) to safely power **5 Metres** of RGBW Mini Neon Flex.
- Ensure that the Neon Flex wires are connected to the correct terminals on the suitable LED Receiver chosen. Please see the diagram above for the correct terminals to attach each wire to.
- *Our range of LED Neon Flex is not limited to RF Control Methods. Many other control options are available for our Neolinear™ Range, including DMX, DALI ZIGBEE & more.

+10% Tolerance on all Specifications. Colours can be variable.

We reserve the right to change specifications without notice. E&OE. If you require Technical support or for general enquiries, please do not hesitate to contact one of our LED Technical experts on the contact information provided.



Opening times
Mon-Thur: 8:30am - 5:00pm
Fri: 8:30am - 4:30pm

Telephone: 01260 540014
www.ledtechnologies.co.uk

Neon Flex Mini Sideview - RGBW (4000K) | NEOLINEAR

Installing the Neon Flex in a profile:

- The Neolinear™ Mini Sideview should be pressed gently with the palm of your hand to insert the Neon into the profile safely.
- Keep the Neon Flex as straight as possible while inserting it into the profile to avoid damaging the product
- **DO NOT** press the Neon Flex down with a single finger. This can easily damage the inside of the Neon and won't be covered under Warranty
- **DO NOT** hold the Neon Flex at a bent angle when installing it into a profile. This can also damage the product if it is bent too much

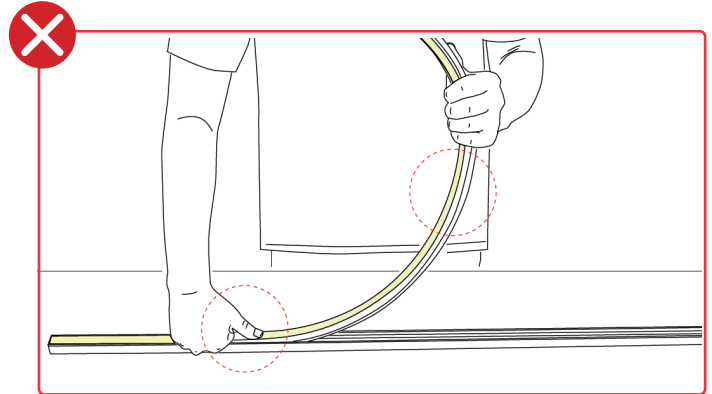
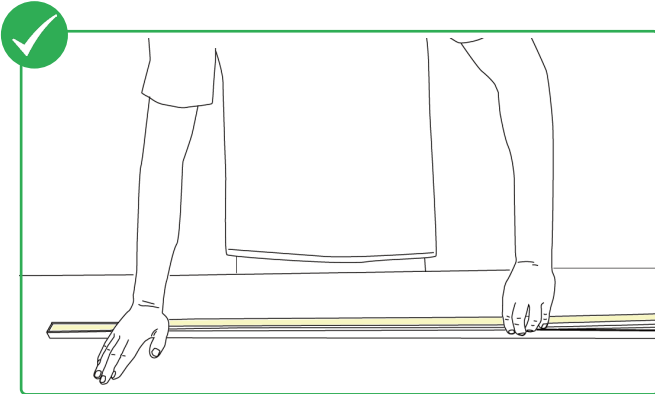

Sideview Installation Guide:

- The Neolinear™ Mini Sideview should be pressed gently with the palm of your hand to safely and slowly install the Neon into place
- Prevent the Neon from drooping and bending in the wrong direction to avoid damaging the product during installation
- **DO NOT** hold the Neon's Luminous Surface or bend the Sideview Neon up or down (pictured below - example 2) as this can damage the Neon
- Hold the Neon Flex by the sides at a 90° angle with your right hand, straightening only when installing it into place
- Ensure the person holding the reel keeps the Neon as straight as possible. Do not twist or pull during the installation

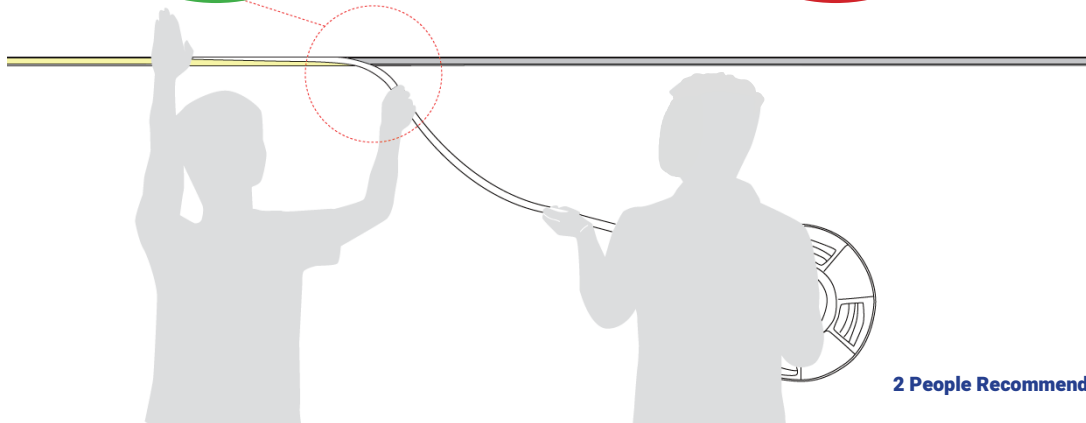
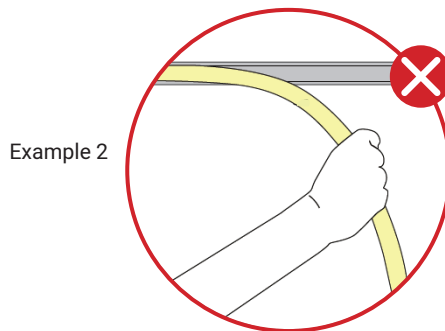
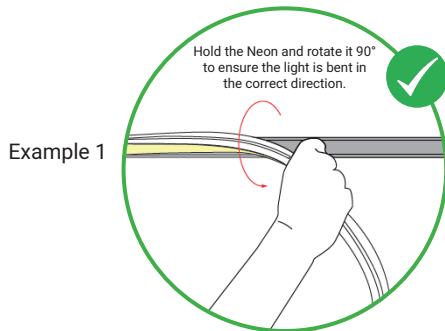

2 People Recommended for Installation

+10% Tolerance on all Specifications. Colours can be variable.

We reserve the right to change specifications without notice. E&OE. If you require Technical support or for general enquiries, please do not hesitate to contact one of our LED Technical experts on the contact information provided.



Opening times
Mon-Thur: 8:30am - 5:00pm
Fri: 8:30am - 4:30pm

Telephone: **01260 540014**
www.ledtechnologies.co.uk